

PermaSEAL Self-Adhesive Tanking Membrane

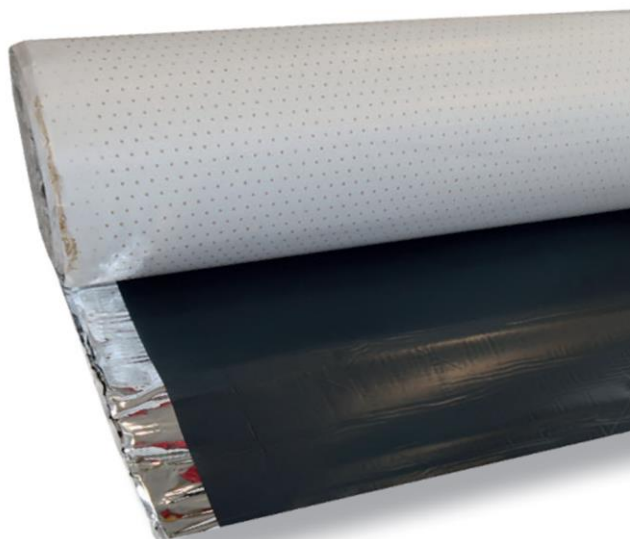

Description

PermaSEAL Self-Adhesive Tanking Membrane is designed to protect below-ground structures from water ingress. The high performance, puncture and tear resistant Valeron film bonded to a high tack bitumen adhesive offers the user a highly efficient way to tank an external below ground structure.

Each PermaSEAL Self-Adhesive Tanking Membrane brings together the following elements:

- a cross-laminated and tough Valeron film that is puncture and tear resistant, and offers immediate protection against water ingress
- a powerful sealing adhesive incorporating bitumen rubber to provide an effective seal on a range of substrates

This combination creates a crack-bridging tanking membrane that is tear-resistant and highly flexible, making it ideal for external applications. It also saves time as you can install PermaSEAL Geodrain Membrane system immediately after application with no waiting time for curing.

NB: PermaSEAL Self-Adhesive Tanking Membrane is designed for use in positive side waterproofing situations, for example, on the outside of basement walls (where positive pressure will be exerted against it). In no instance should this product be used internally as a tanking membrane.

Advantages

- Quick and easy installation
- Suitable for application to a range of substrates including ICF, preformed concrete and other prepared mineral surfaces
- Puncture & tear-resistant
- Highly flexible and crack-bridging
- 1.5mm thick membrane
- Cold applied system
- Conforms to BS 8102:2009 – Code of practice for protection of below ground structures against water from the ground as a Type A (Barrier) System.

Preparation

All contact surfaces must be clean and sound. Remove all loose material, nibs, laitance, dust and any previous coatings back to clean brickwork, masonry or concrete.

Please note: surfaces must be smooth and void free, in the instance of concrete blocks, surfaces with air entrapped in them or random stone walls we suggest 3:1 sand/cement levelling coat with the addition of Permagard SBR should be applied to provide a sound, even base prior to the application of PermaSEAL Self-Adhesive Tanking Membrane.

Priming

PermaSEAL Self-Adhesive Tanking Membrane should only be applied in dry conditions to a dry substrate in temperatures between 5°C and rising or 25°C and falling.

Prime all mineral substrates with a bituminous primer. ICF should be primed with a water-based primer. The primer produces a slightly tacky surface that is ideal for waterproofing with cold applied self-adhesive sheets. Substrates should be as dry as possible so that the primer can partially penetrate into them. Wet substrates should be sealed with PermaSEAL Tanking Slurry a few days before the primer is applied, making sure the slurry is brushed smooth. Cover the entire surface with primer and allow it to dry. **The drying time should be no less than 1.5 hours and no more than 24 hrs.**

Before application, the primer should be checked for condensation that may have formed on the surface, if this occurs application must wait until the surface is dry.

Primed surfaces should be waterproofed within 2 - 6 hours (on the same day) as the primer will otherwise lose its adhesion-friendliness because dirt and dust will settle on it again.

Application

Please see separate installation instructions for full guidance on how to install this system.

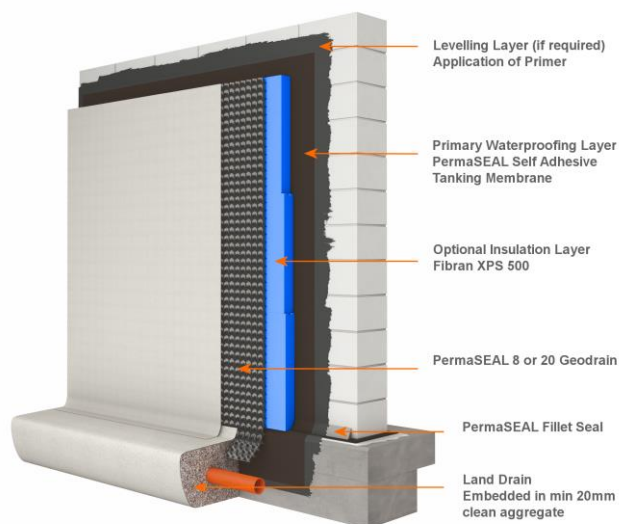

Application Notes

PermaSEAL Self-Adhesive Tanking Membrane should not be applied to damp, frost filled surfaces or when the temperature is 5°C and falling or 25°C and rising.

Curing

As soon as PermaSEAL Self-Adhesive Membrane is fully adhered to the surface and detailed correctly it is water tight.

Application of XPS Insulation and/or PermaSEAL Geodrain can be performed as soon as installation is completed, no drying time is required.

Coverage

A single roll of PermaSEAL Self-Adhesive tanking membrane will cover up to 15m². However, jointing requires a 50mm - 100mm overlap, detailing and reinforcement strips will also be cut from the same material, all of which should be considered.

Technical Data

Material	Cross-laminated HDPE Valeron film coated on the underside with a polymer-modified bitumen compound
Size	1.00m x 15.00m (15m ²)
Thickness (EN 1859-1)	1.5 mm
Weight (EN 1859-1)	1.6kg/m ²
Watertightness (EN 1928, procedure B)	≥ 4 bar in 24 hours
Tensile strength (EN 12311-1)	md 275, cd 300 [N/50mm]
Elongation (EN 12311-1)	> 150%
Shear resistance of the joining seams (EN 12317-1)	md/ cd > 200 N
Tear resistance (EN 12310-1)	md/ cd > 150 N
Resistance to static load (EN 123730)	≥ 20kg
Cold bending behaviour	- 30°C
Water vapour permeability (EN ISO 12572)	sd > 150m
Straightness (EN 1848-1)	3 mm / 10 m
Fire class (EN 13501-1)	E-d2
Radon density	dense

Packaging

Single roll dimensions 1.00m x 15.00m packaged in a protective cardboard box.

Storage and Shelf Life

PermaSEAL Self-Adhesive Tanking Membrane should be stored up right in its original box to ensure the membrane does not become deformed. It should be stored in cool dry conditions away from direct sunlight at a temperature of 5°C to 25°C.

Health and Safety

Refer to latest health and safety data sheet.